



# **GURTEC**

.... conveying with passion

**Rollers**  
**Frames & Garlands**  
**Pulleys**  
**Accessories**

- ≡ **High quality – Made in Germany**
- ≡ **Industry benchmark**
- ≡ **Flexible solutions**
- ≡ **Custom-made rollers**
- ≡ **No minimum order quantity**
- ≡ **50 years of experience**
- ≡ **Highly customer focussed**
- ≡ **Strong market presence**
- ≡ **Motivated and experienced staff**
- ≡ **Reliability and passion**

## **GURTEC is back**

Around 50 years ago GURTEC was established as a small family business. Today, after the acquisition by NEPEAN, the brand GURTEC is back and stronger than ever:

Well-known GURTEC quality with a strong track record of high quality conveyor components supported by the strength and flexibility of a privately-owned international company.

1969 – Foundation of GURTEC in Bremerhaven



1976 – Relocation to Schöppenstedt



1980 – Automated GUP roller production



2005 – HM140/150 roller production



2015 – Automated GST roller production



2017 – NEPEAN becomes the new owner



# GUP GST

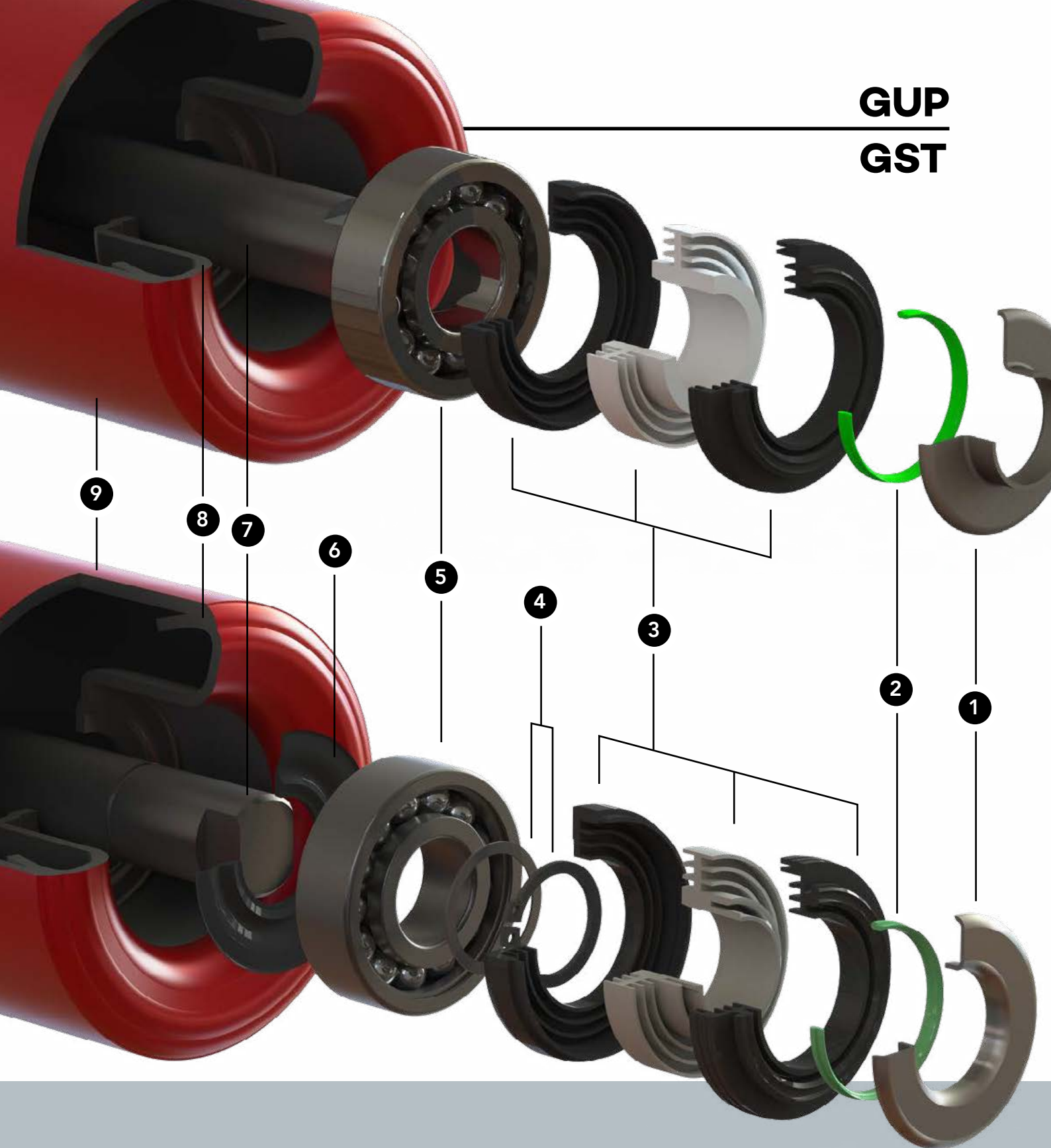

**1 | Dust cap and splash protection**

**2 | Additional lip seal – optional**

**3 | 6-way labyrinth seal from own production**

The smallest possible distance between the separate labyrinth channels and the perfectly dimensioned grease chamber guarantee a durable sealing system for all applications.

**4 | Sealing ring and washer (only GST)**

**5 | Deep groove ball bearing – clearance C4 with cage made of fiberglass reinforced polyamide 6.6**

**6 | Rear bearing seal (only GST)**

**7 | Shaft – Availability of all shaft ends, shaft diameters 17-60 mm and reinforced shaft diameter between bearings.**

**8 | Bearing housing**

welded to the roller shell (dust- and waterproof)

**9 | Roller tube – welded special roller tube with tolerances exceeding DIN standards**

**Roller shell – blasted SA 2.5 and powder coated (RAL3000) with layer thickness of approximately 60 µm**



## CUSTOM-MADE ROLLERS

GURTEC can produce custom-made rollers to suit the customer's specific needs regardless of the design specification and quantity required.

For example: Sprocket wheel roller, stub roller, side-guide roller, conical roller, double-toothed belt roller, tapping roller and many more.



## HM 150

1

2

3

4

### 1 | Flow-formed roller tube

Excellent balancing quality (<G16 according to ISO 1940) and concentricity <0.3. Due to the tube forming process, there is no need for dynamic balancing and machining. This allows high belt speeds and increased capacity while decreasing noise emission. The solidified surface of the roller shell leads to reduced wearing of the tube.

### 2 | Multi-channel labyrinth seal from own production

effectively keeps dirt, dust and moisture away from the bearing – increases bearing life.

### 3 | Integrated bearing seats by end-forming

The tube ends are formed into bearing housings. This means that no separate bearing housings and welding are needed. Belt friendly – no sharp edges.

### 4 | Cold-forged high-precision hollow shaft

instead of a solid steel shaft, which reduces weight and cost while also giving less deflection.

## ≡ Frames & Garlands



## ≡ Pulleys



## ≡ Belt Cleaners



Belt cleaners with hard metal, PU or ceramic blades

Belt brush

Air knife

Plow cleaner

## ≡ Safety & Monitoring Equipment



Pull cord emergency stop switch

Belt misalignment switch

Belt rip detector



Rotation speed monitor



Blocked chute detector



Belt-tracking roller

## ≡ HX 270

Automated on-line Conveyor Belt Monitoring and Control System

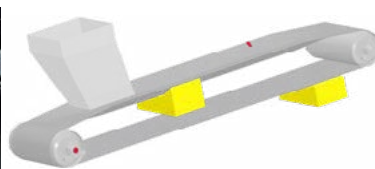



# GURTEC

**Your partner for  
Conveyor Components  
in Europe, Africa and  
the Middle East.**

GURTEC GmbH  
Gurtecstrasse 3  
38170 Schöppenstedt  
Germany  
Tel: +49 5332 9309 8900

GURTEC GmbH  
Lyrenstrasse 13  
44866 Bochum  
Germany  
Tel: +49 2327 5446 377

Mail: [info@gurtec.com](mailto:info@gurtec.com)  
[www.gurtec.com](http://www.gurtec.com)

Your GURTEC-Partner:

GURTEC IS A MEMBER OF

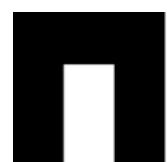

**NEPEAN**  
Conveyors